

SLB Connectors

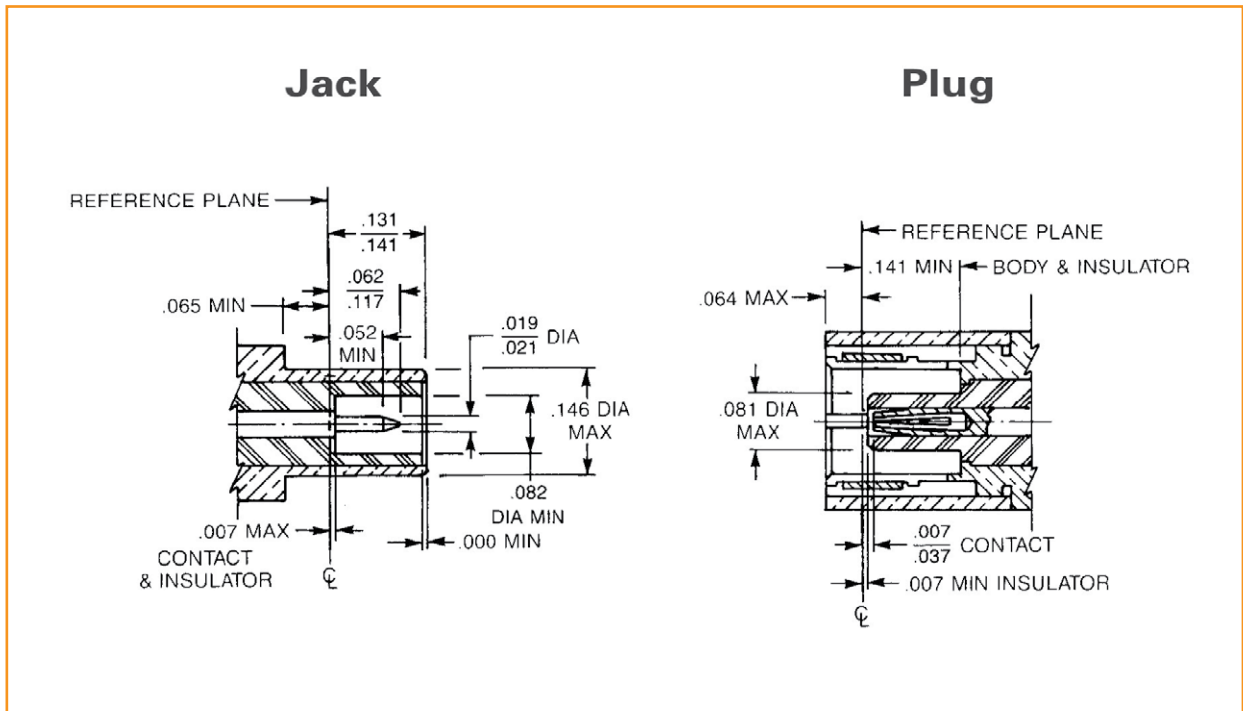

SLB Connectors

Interface Mating Dimensions (Per MIL-PRF-39012)



Bullhead Receptacle Plug

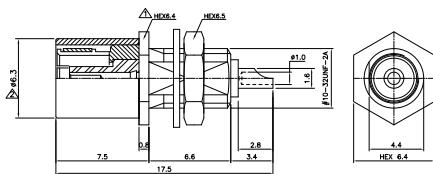

Bullhead Receptacle Jack

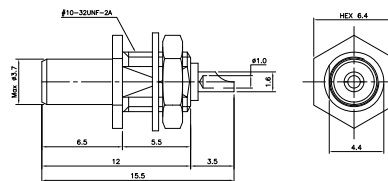

Straight Plug for RG178

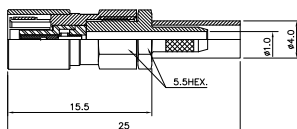

Straight Plug for RG316

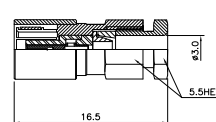

SLB Connectors

Straight Plug for RG58

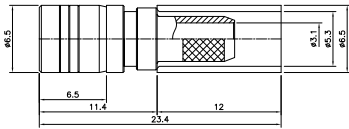

Part No.

SLB-112-001

Straight Jack for RG316

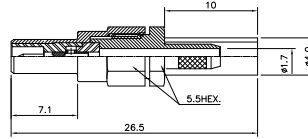

Part No.

SLB-211-001

Right Angle Plug for RG316

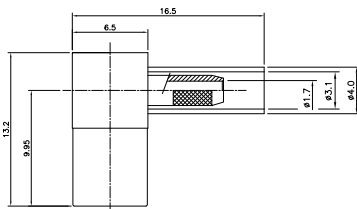

Part No.

SLB-311-001

Right Angle Plug for RG58

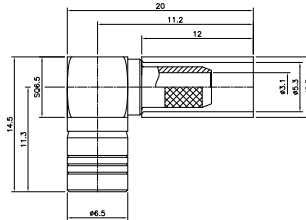

Part No.

SLB-312-001

Bulkhead Plug for RG178

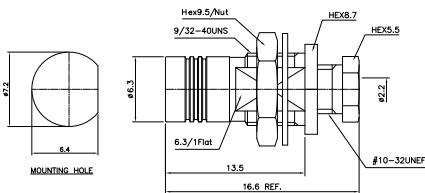

Part No.

SLB-410-002

Bulkhead Plug for RG316

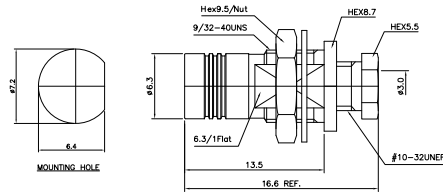

Part No.

SLB-411-003

